

# OPTONICA

## USER MANUAL

### HEXAGON

Dear customer, thank you for your trust and purchase of our product. Before installation, please read this manual carefully and keep it for future reference. Installation may only be performed by qualified personnel. These products are powered by 165-265V and may cause a risk of electric shock or fire if not properly installed or operated. The products must be installed in accordance with this manual and the regulations in force in the country. To minimize the risk of fire, electric shock or other accidents, make sure that the product is not connected to the power supply before installing or connecting the light modules.

### WARNINGS



- Do not cover this product, as covering it may cause the lamp to overheat, melt or catch fire.
- Do not route the power cable or light through walls, doors, windows or similar structures.
- Do not use if the lamp or power cable is damaged. Check regularly.
- Do not carry out any repairs to the product or its parts. Repairs may only be carried out by specialist personnel.
- Do not install in cabinets, containers or other tight and confined spaces.
- Do not install in rooms containing flammable materials such as flammable gases or flammable particles.
- Only attach the product to permanent structures.
- Do not attach the product or power cable using rivets, nails or other similar fastening methods that may cause damage. Keep the product, power cable and other parts of the lamp out of the reach of children and animals.
- Turn off the lamp if you leave it unattended. Disconnect the power supply before maintaining the product.
- Do not use any cleaning agents to clean the lamp, use dry and soft materials for cleaning.

### WARRANTY

The product is covered by a 24-month warranty covering material and manufacturing defects and devices that have been damaged during normal use. The warranty does not cover products damaged if the user has not followed the instructions or if the product has been modified in design.

### INSTALLATION

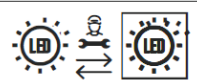
The installation must be carried out by a licensed electrician. Assemble the lamp before mounting on the ceiling using the supplied connecting elements. Please note that each connecting element with a mounting hole must be permanently attached to the structure of the space so that the weight of the light assembly is evenly distributed. The connecting element containing the power connection is installed in the corner of the light assembly. Check the connection before mounting on the ceiling.

	
Light source replaceable (LED only) by a professional	Interchangeable control gear by a professional



This product should be disposed of responsibly at the end of its life. Please recycle where facilities exist. Check with your Local Authority or retailer for recycling advice (Waste Electrical and Electronic Equipment Directive)

### INSTALLATION INSTRUCTIONS

1. Disconnect the power.
2. Assemble the whole set
3. Connect the cables: Brown wire - phase wire (L) / Blue wire - neutral wire (N)
4. Attach the mounting plates to the location.
5. Attach the kit to the mounting plates
6. Turn on the power

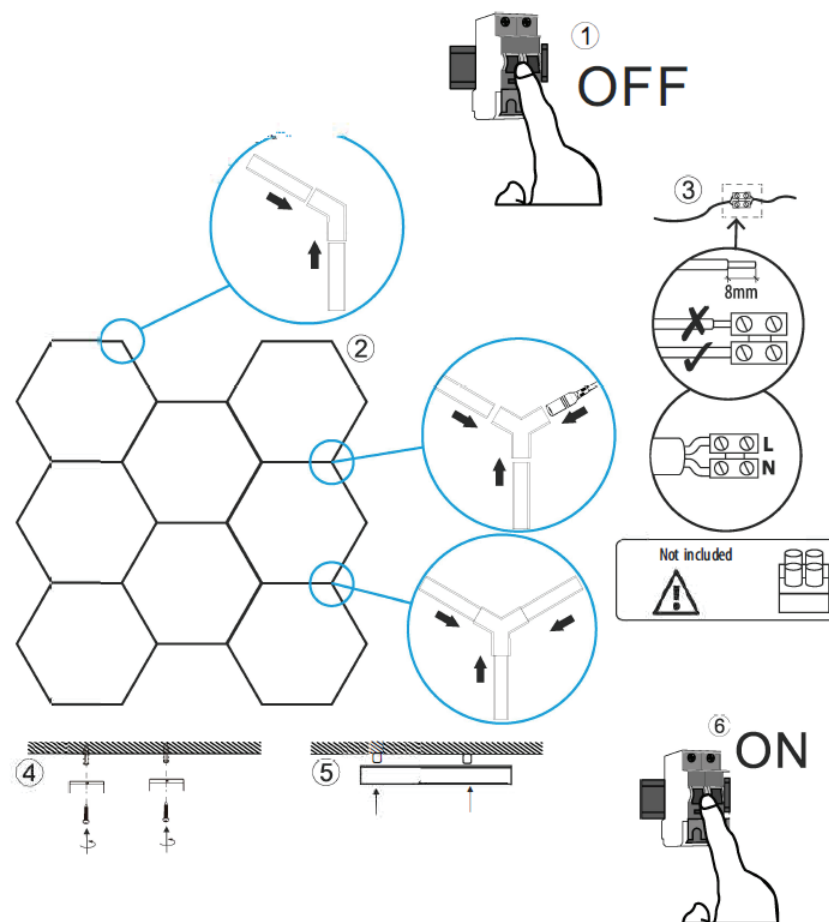

IMPORTER: Prima Group 2004 LTD, Bulgaria, 1582 Sofia, Druzhba 2, Blvd. "Prof. Tsvetan Lazarov" 126A, 4th floor; Phone: +359 2 988 45 72;