

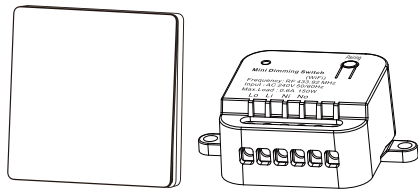

80*80mm

OPTONICA
User Manual



 Kinetic Switch SET
ON/OFF + Dimmer

IMPORTER: Prima Group 2004 LTD, Bulgaria, 1784 Sofia,
Mladost 1, bl. 144, Ground Floor; Phone: +359 2 988 45 72;

Product combination:

Switch:7655 , 7656
Controller:(Dimming)Wi-Fi
Product Code : S2-A1

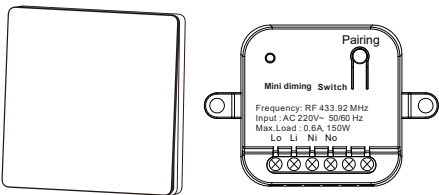

Specification of Switch:

Model: 7655 ; 7656

Type: 1 Gang

Dimension: 86L x 86W x 15D(mm)

Life Time: >25,000 Times

Frequency: 433MHz

IP Rate: IP44



Cautions:

1. Avoid installing switch on metal surface, that may seriously affect the operation range.
2. Range may vary dramatically in different environments.

Specification of Conrtoller:

Type: (Wi-Fi)

Dimension: 43.8L x 43.8W x 22D(mm)

Max Load : : AC110V-240V~ 50/60Hz, <150W (LED)

Frequency: 433MHz

IP Rate: IP20

1. Press and hold the kinetic switch for 3 seconds to enter dimming mode. The light will gradually turn on from dark to bright, then cycle by cycle between bright and dark continuously until the switch is released.
2. User can install "Smart Life" app to control the lightings in house.



Cautions:

1. Range may vary dramatically in different environments.
2. The controller is not available to work with air conditioner, pump, or any other appliance (Max Load Stated Above).
3. Be sure which one is live wire before shut down the power and install the controller.

Installation:

1. Use the double-sided tape to install.

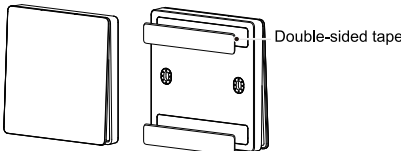

2. Use the screws and anchors to install.

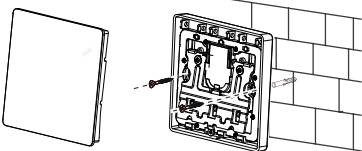

* The switch is available for portable use of indoor.

Installation:

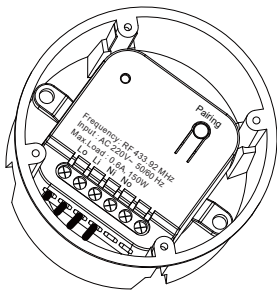

Cautions:

The controller will not work if connection of input and output wires is wrong.

Now: (WiFi):

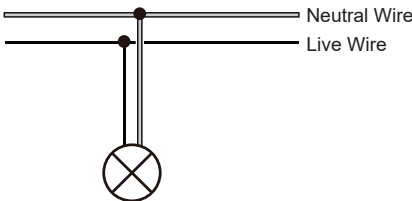

Next:

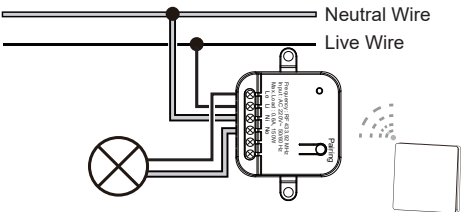

How to pairing:

Be sure to pairing the switch and controller before usage.

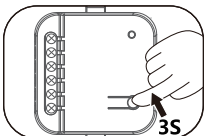

1. Hold 3 secs.

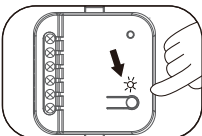

2. Release once LED flashes.

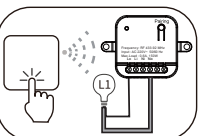

3. Press the switch.

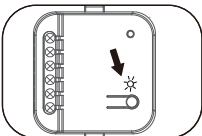

4. LED flashes once pairing completed.

How to Reset:

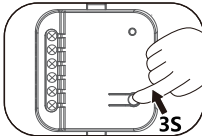

1. Turn off the breaker, press the pairing button, and power it on for 3 seconds.

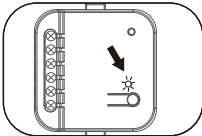

2. LED flashes.

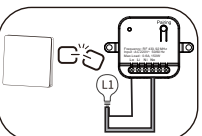

3. Release the button, reset is completed.