

# OPTONICA

## РЪКОВОДСТВО ЗА УПОТРЕБА - LED ВЕНТИЛАТОР ЗА ТАВАН

SKU: 19111, 19112

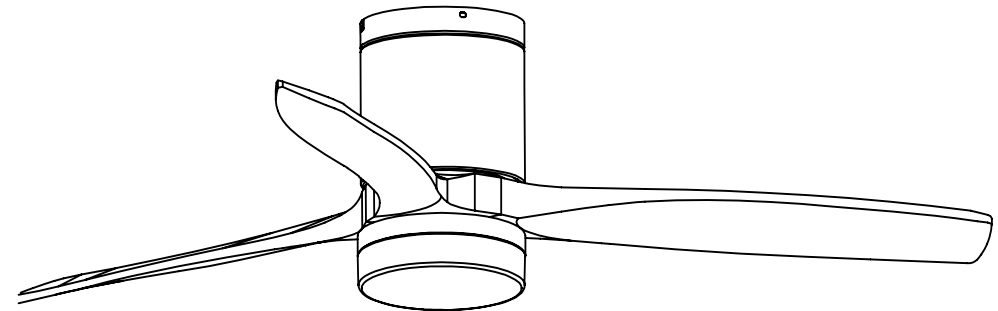

## Предупреждения и Оповещения

- Прочетете цялото ръководство внимателно, преди да започнете инсталацията. Запазете тези инструкции.
- Използвайте само оригинални резервни части.
- За да намалите риска от наранявания, прикрепете вентилатора директно към опорната структура на сградата, съобразно с тези инструкции, и използвайте само предоставените хардуерни компоненти.
- За да избегнете възможен електрически шок, преди да инсталирате вентилатора, изключете захранването, като изключите прекъсвачите на ел. инсталацията и съответния прекъсвач на стената. Ако не можете да заключите прекъсвачите в изключено положение, прикрепете сигурно забележим предупредителен знак, като етикет, към електрическото табло.
- Всички проводници трябва да бъдат монтирани в съответствие с националните и местни електрически норми и ANSI/NFPA 70. Ако не сте запознати с електрическото окабеляване, използвайте квалифициран електротехник.
- За да намалите риска от наранявания, не огъвайте системата за закрепване на лопатките при инсталиране, балансиране или почистване на вентилатора. Никога не поставяйте чужди предмети между въртящите се лопатки на вентилатора.
- За да намалите риска от пожар, електрически шок или повреда на мотора, не използвайте контролер за скорост със солидно състояние с този вентилатор. Използвайте само оригинални контролери за скорост.

**ЗАБЕЛЕЖКА:** Важните предпазни мерки и инструкции, посочени в ръководството, не са предназначени да покрият всички възможни условия и ситуации, които могат да възникнат. Трябва да се разбере, че здравият разум и предпазливостта са необходими фактори при инсталирането и експлоатацията на този вентилатор.

## Събиране на абажур

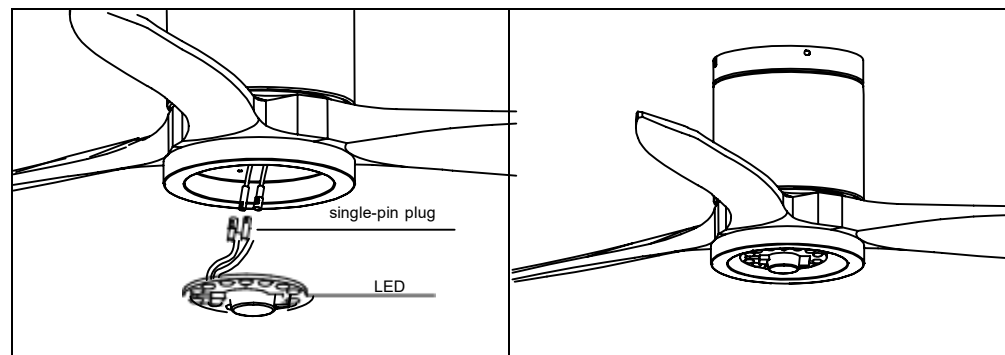

Възстановете капака и абажура обратно към LED панела.

## Инвентаризация на декоративния панел

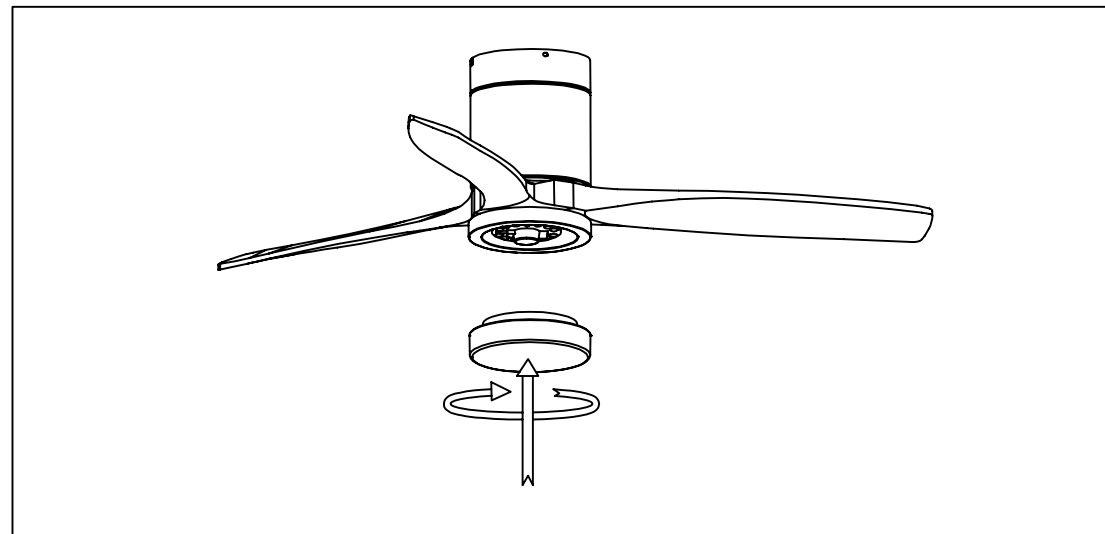

Възстановете капака и абажура обратно към LED панела и ги закрепете с декоративни клипове и болтови гайки.

## Поставяне на перките

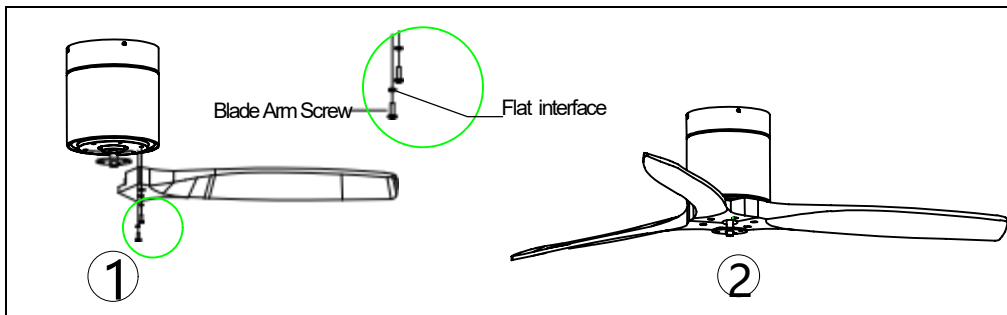

Спестяване на време: Може да поставите шайби върху винтовете за перките преди да ги инсталирате.

Изравнете отворите на перките с отвора на винтовете на мотора. Затегнете всички винтове, след като всички перки са прикрепени. Преди да затегнете винтовете окончателно, повторете процедурата с останалите рамена на перките.

Забележка: Затегнете винтовете за перките два пъти.

## Събиране на LED панела

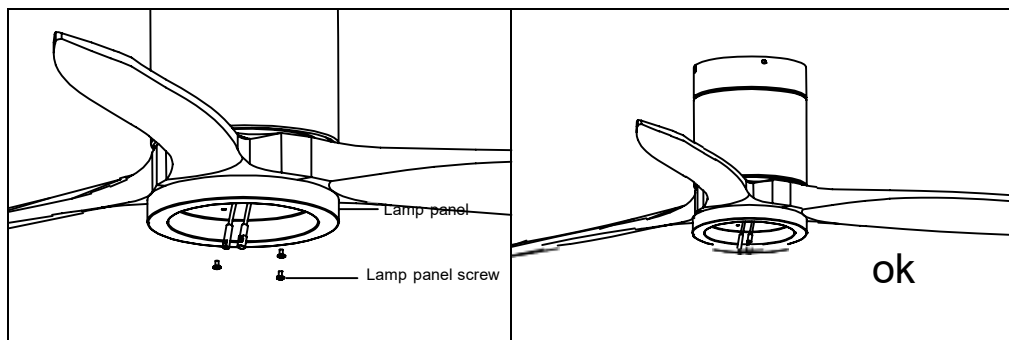

Отстранете един винт. Прикрепете LED панела към долната част на вентилатора, като поставите другите два винта в ключалките на панела, завъртете го на място, след това закрепете предишния винт, като изравните винтовото отворче и отвора в долната част на вентилатора, и затегнете останалите два винта, за да закрепите LED панела.

**ЗАБЕЛЕЖКА:** При инсталиране или премахване на LED панела, моля, внимателно запазете изолационните подложки. Затягането на винтовете прекалено силно или бързо може да увреди изолационните подложки.

## Инвентаризация на частите

Внимателно отворете опаковката. Премахнете елементите от стиропорените вложки. Премахнете мотора и го поставете върху килим или стиропор, за да избегнете повреда на покритието. Проверете срещу инвентаризацията на частите дали всички части са включени.

- Удължителен прът и окачваща топка

Кръстачка за окачване	Дистанционно управление	Спирална опаковка
Перка	Мотор	Лампов панел
Съкло	LED източник на светлина	Спирална опаковка
Дистанционно		

## Монтиране на кръстачката за окачване

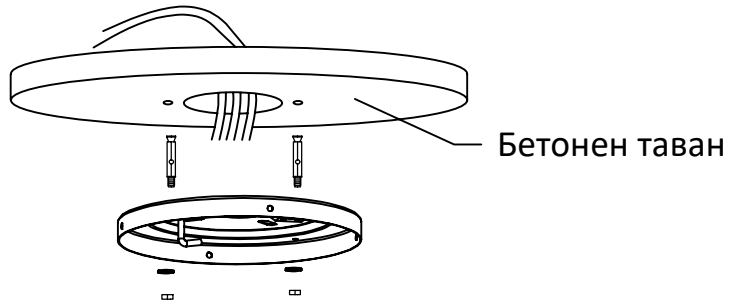
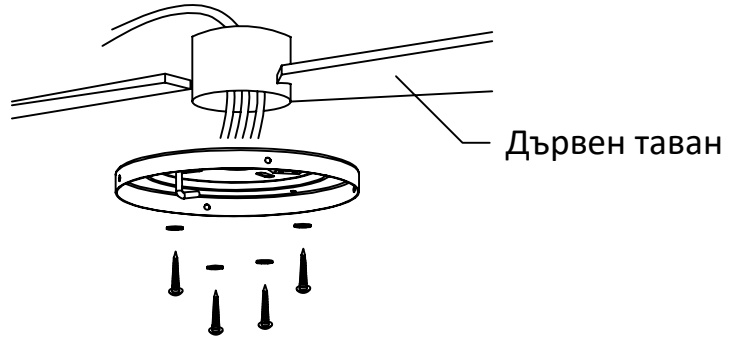

Моля, пробийте дупка с диаметър 8мм в бетонния таван и поставете болта. Изравнете кръстачката с дупката, след което затегнете с гайка.

## Свързване на дистанционното управление

AC:

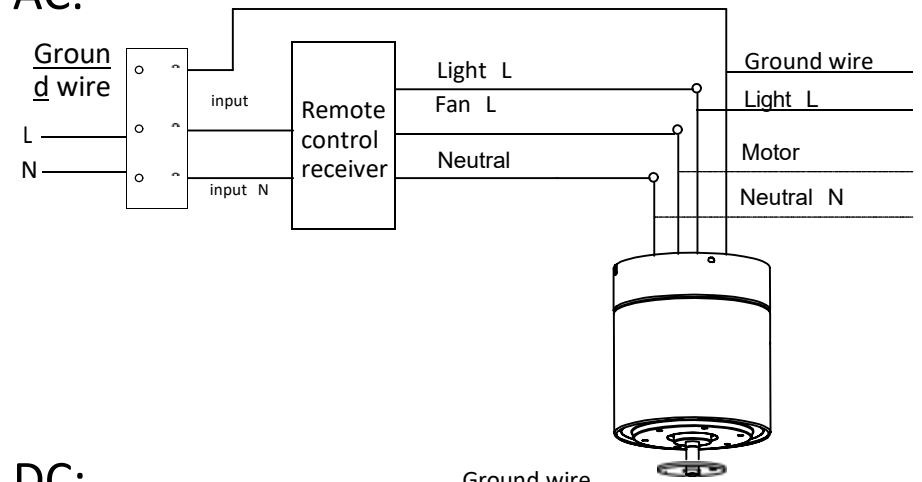

DC:

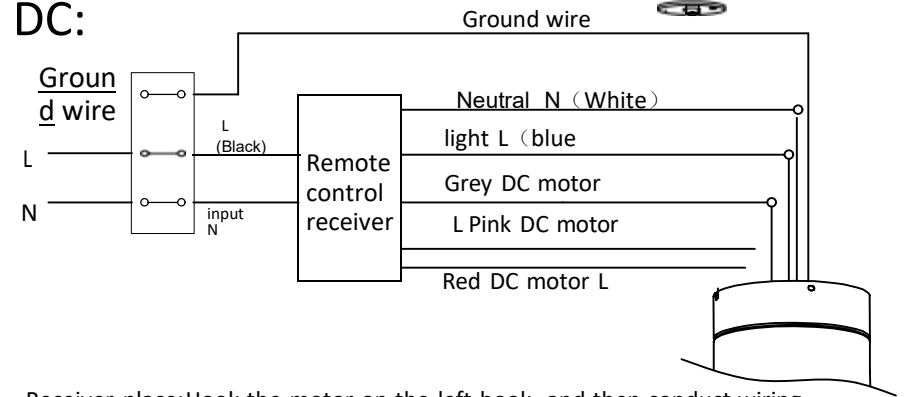

Receiver place: Hook the motor on the left hook, and then conduct wiring

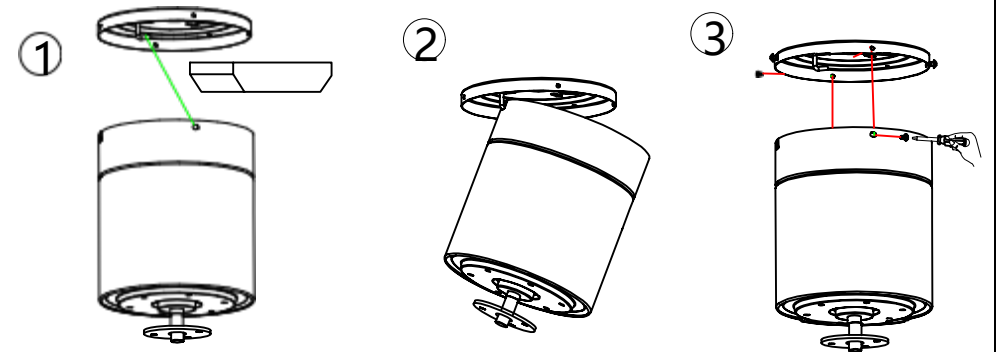

# OPTONICA

## Bedienungsanleitung – LED-DECKENVENTILATOR

SKU: 19111, 19112

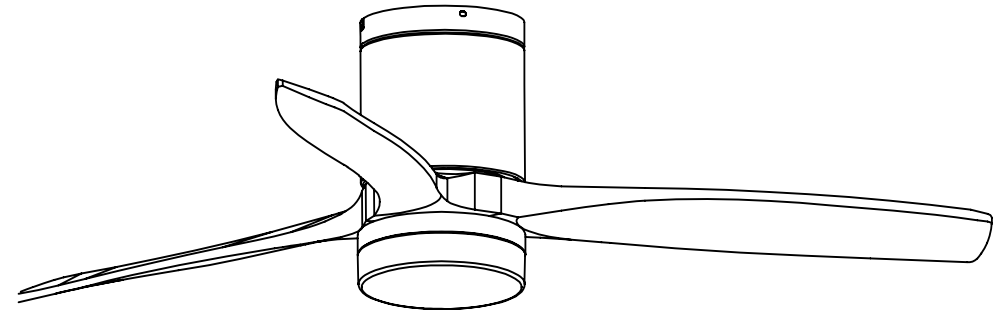

## Vorsichtsmaßnahmen und Hinweise

LESEN SIE DIE GESAMTE ANLEITUNG SORGFÄLTIG DURCH, BEVOR SIE MIT DER INSTALLATION BEGINNEN. BEWAHREN SIE DIESE ANWEISUNGEN AUF.

- Verwenden Sie nur Original-Ersatzteile.
- Um das Verletzungsrisiko zu verringern, befestigen Sie den Ventilator gemäß dieser Anleitung direkt an der Tragkonstruktion des Raumes und verwenden Sie ausschließlich das mitgelieferte Zubehör.
- Um einen möglichen Stromschlag zu vermeiden, trennen Sie vor der Installation Ihres Ventilators die Stromversorgung, indem Sie die Sicherung ausschalten.
- Wenn Sie die Sicherung nicht in der Aus-Position verriegeln können, befestigen Sie ein auffälliges Warngerät, z. B. ein Schild, sicher sowie sichtbar an der Wartungstafel.
- Die gesamte Verkabelung muss den nationalen und örtlichen Elektrovorschriften sowie ANSI/NFPA 70 entsprechen. Wenn Sie mit der Verkabelung nicht vertraut sind, wenden Sie sich an einen qualifizierten Elektriker.
- Um das Verletzungsrisiko zu verringern, verbiegen Sie das Flügelbefestigungssystem nicht, wenn Sie den Ventilator installieren, ausbalancieren oder reinigen. Führen Sie niemals Fremdkörper zwischen rotierende Lüfterflügel ein.
- Um das Risiko von Bränden, Stromschlägen oder Motorschäden zu verringern, verwenden Sie bei diesem Ventilator keine elektronische Drehzahlregelung. Verwenden Sie nur Original-Geschwindigkeitsregler

**Hinweis:** Die in der Bedienungsanleitung angeführten Warnungen und Hinweise können nicht alle Umstände der Montage, des Betriebs und der Wartung abdecken. Bitte handeln Sie in allen beschriebenen Situationen sorgfältig um Verletzungen, Schäden oder Störungen durch Anwendungsfehler zu vermeiden.

## LED-Platine

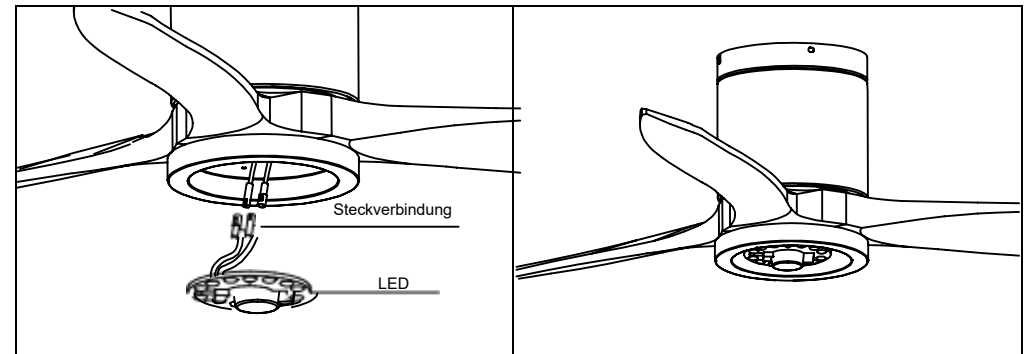

Verbinden Sie die LED-Platine an den zwei Steckverbindungen mit der Lampe.

## Milchglasabdeckung

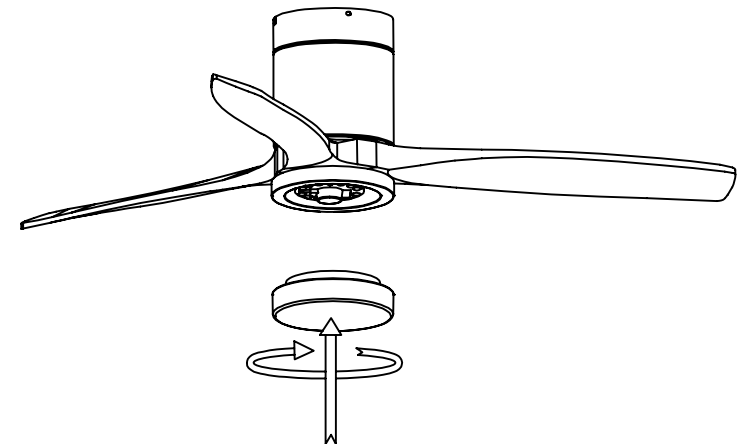

Bringen Sie die Abdeckung Lampe an und befestigen Sie sie mit Zierklammern und Schraubenmuttern.

## Blattmontage

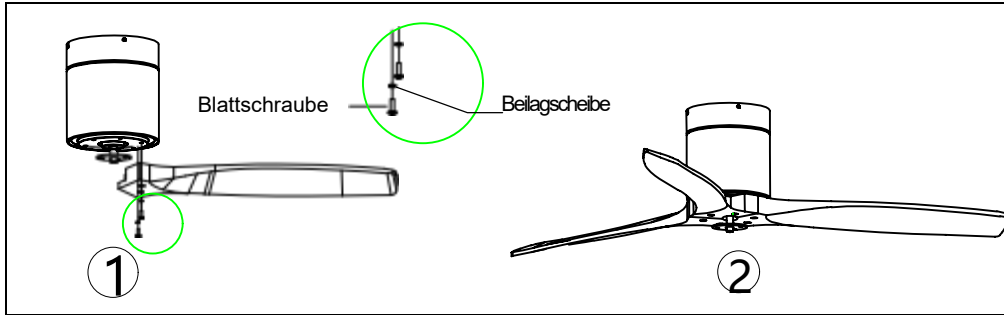

**Zeitersparnis:** Beilagscheiben können vor der Installation der Blätter an jeder Schraube angebracht werden.  
Richten Sie die Löcher mit den Schraubenlöchern des Motors aus. Ziehen Sie alle Schrauben fest, sobald alle Blätter angebracht sind. Bevor Sie die Schrauben dauerhaft befestigen, wiederholen Sie den Vorgang mit den übrigen Blättern.  
**Hinweis:** Schrauben zweimal festziehen.

## Montage LED-Schale

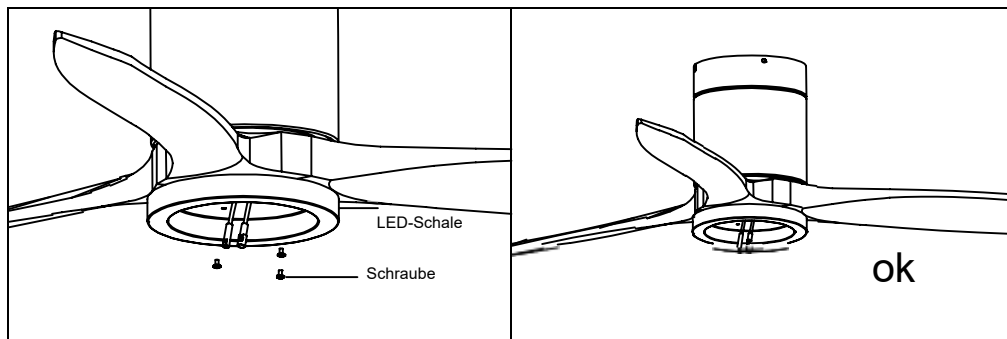





Lösen Sie eine Stellschraube. Befestigen Sie die Wanne an der Unterseite des Lüfters, indem Sie die anderen beiden Stellschraubenköpfe in die Schlüssellochschlitze einsetzen, drehen Sie sie, um sie zu platzieren, befestigen Sie dann die vorherige Stellschraube, indem Sie das Schraubenloch und das Loch an der Unterseite des Lüfters ausrichten, und ziehen Sie sie fest. Die restlichen zwei Stellschrauben befestigen die LED-Schale.

**HINWEIS:** Achten Sie beim Installieren oder Entfernen der LED-Schale darauf, dass die Isolierpads sorgfältig intakt bleiben. Wenn Sie die Stellschrauben zu fest oder zu schnell drehen, werden die Isolierpads beschädigt.

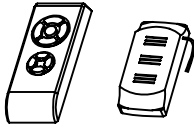
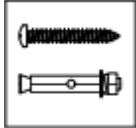
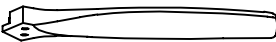
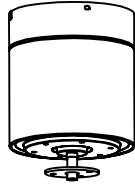
## Packungsinhalt

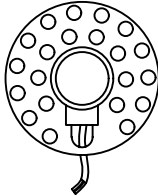
Öffnen Sie die Verpackung vorsichtig. Entfernen Sie Gegenstände aus den Styroporeinsätzen. Entfernen Sie das Motorgehäuse und legen Sie es auf einen Teppich oder Styropor, um Schäden an der Oberfläche zu vermeiden. Überprüfen Sie anhand der Liste, ob alle Teile enthalten sind.

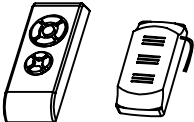
		
Deckenhalterung	Fernbedienung	Schrauben/Dübel
		
Rotorblätter	Motor	LED-Schale
		
Milchglasabdeckung	LED-Platine	Schrauben/Dübel
		
Fernbedienung		

## Installation Deckenhalterung

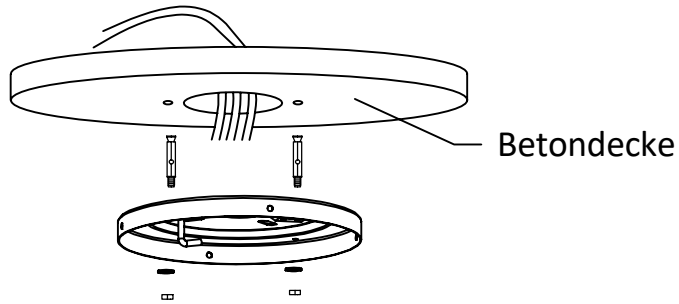
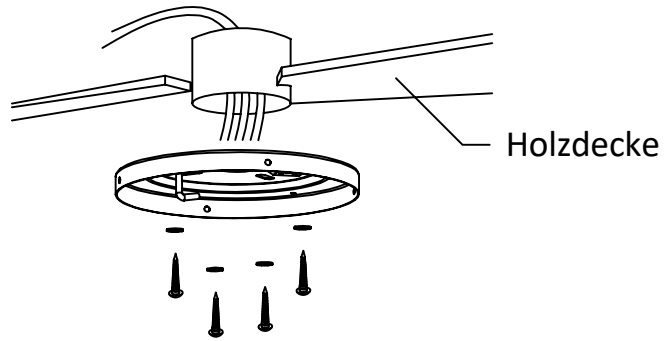

Bitte bohren Sie ein Loch mit einem Durchmesser von 8 mm in die Betondecke und setzen Sie die Schraube ein. Richten Sie die Halterung am Loch aus und ziehen Sie sie dann mit der Mutter fest.

## Installation Empfänger für Fernbedienung

AC:

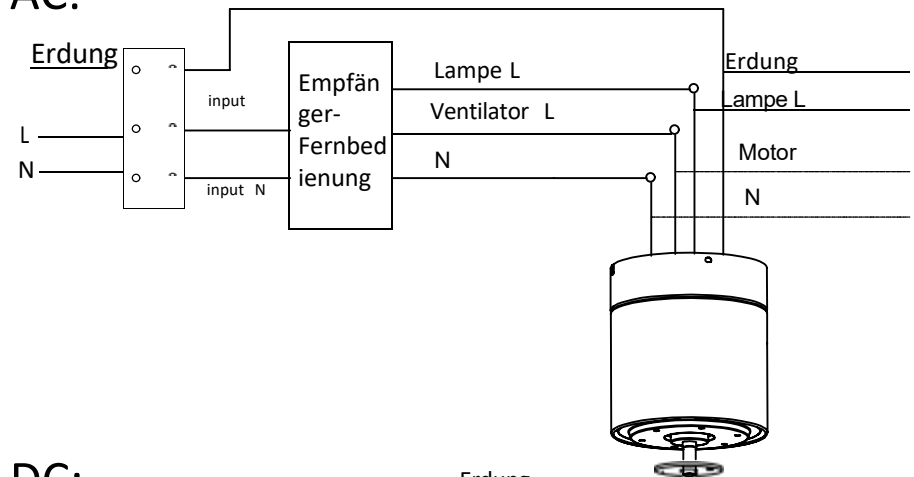

DC:

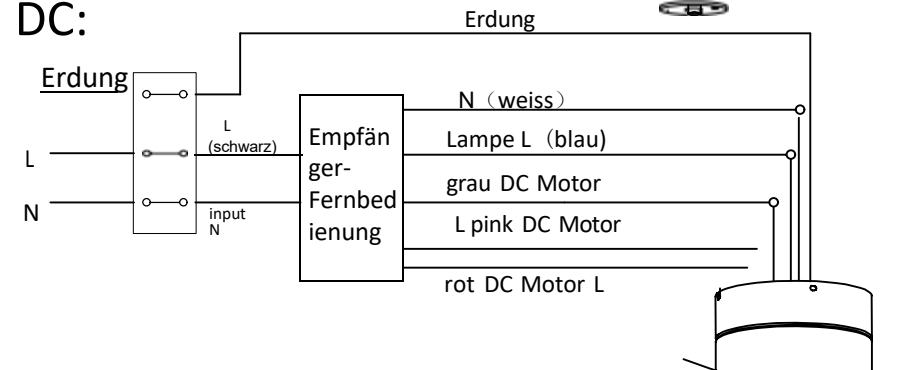

Empfängerplatz: Hängen Sie den Motor am linken Haken ein und führen Sie dann die Verkabelung durch

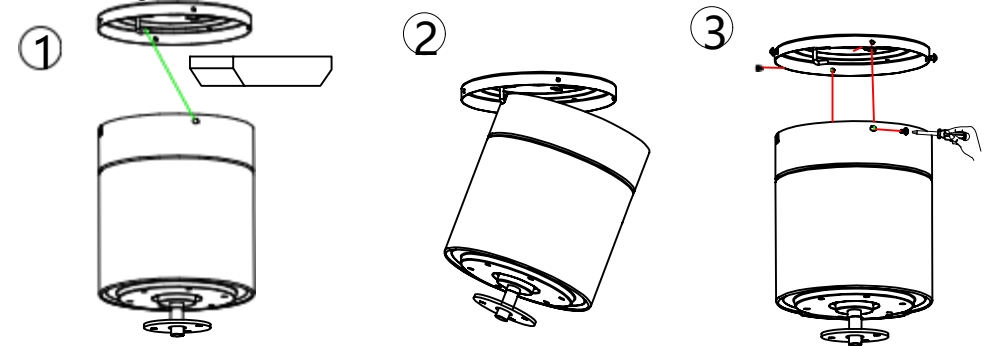

# OPTONICA

## USER MANUAL - LED FAN CEILING

SKU: 19111, 19112

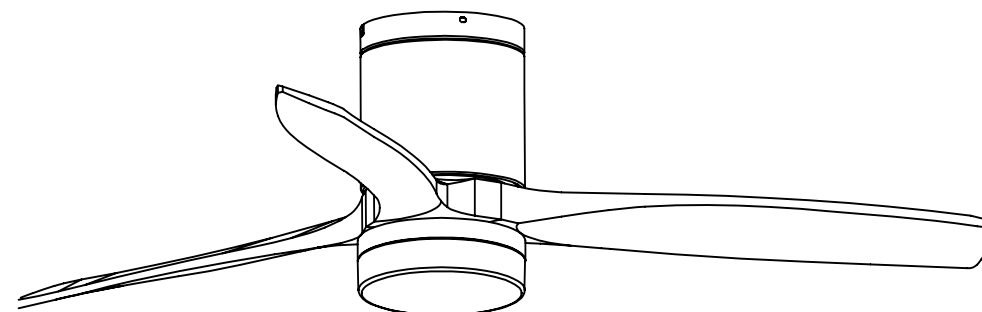

## Cautions and Warnings

- READ THIS ENTIRE MANUAL CAREFULLY BEFORE BEGINNING INSTALLATION. SAVE THESE INSTRUCTIONS.
- Use only original replacement parts.
- To reduce the risk of personal injury, attach the fan directly to the support structure of the building according to these instructions, and use only the hardware supplied.
- To avoid possible electrical shock, before installing your fan, disconnect the power by turning off the circuit breakers to the outlet box and associated wall switch location. If you cannot lock the circuit breakers in the off position, securely fasten a prominent warning device, such as a tag, to the service panel.
- All wiring must be in accordance with national and local electrical codes and ANSI/NFPA 70. If you are unfamiliar with wiring, use a qualified electrician.
- To reduce the risk of personal injury, do not bend the blade attachment system when installing, balancing, or cleaning the fan. Never insert foreign objects between rotating fan blades.
- To reduce the risk of fire, electrical shock, or motor damage, do not use a solid-state speed control with this fan. Use only original speed controls

NOTE: The important safety precautions and instructions appearing in the manual are not meant to cover all possible conditions and situations that may occur. It must be understood that common sense and caution are necessary factors in the installation and operation of this fan.

## Lamp Shade Assembly

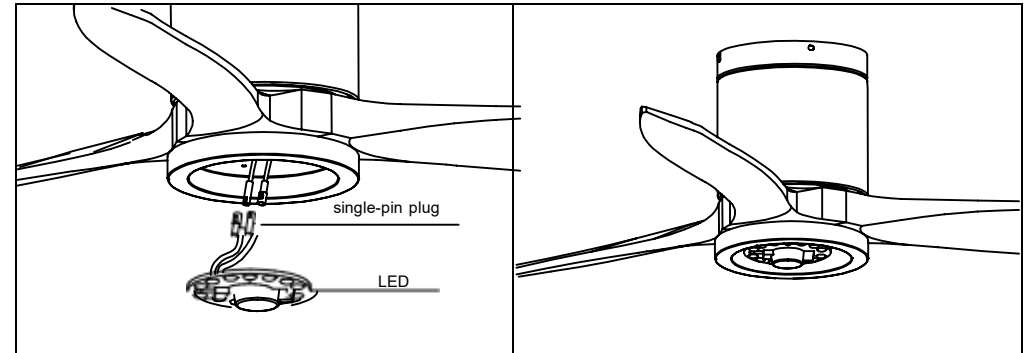

Restore the cover and the lampshade back to the LED pan.

## Decorative Pan Inventory

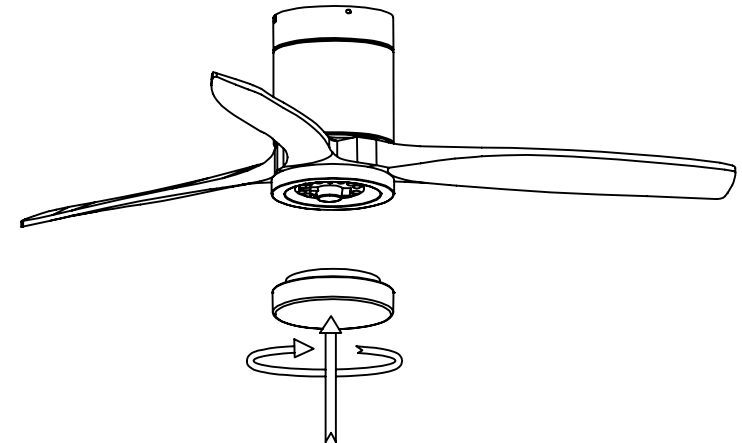

Restore the cover and the lampshade back to the LED pan, and secure them with decorative clips and bolt nuts.

## Blade Assembly

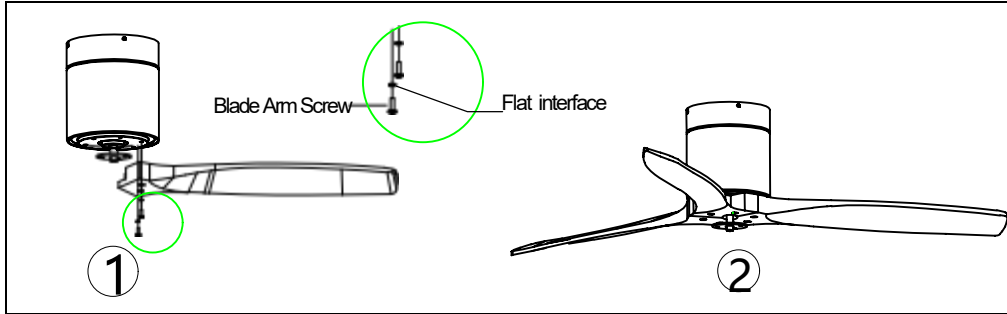

Time Saver: Washers for blade screws can be set on each blade screw prior to installing blades.

Align blade holes with motor screw holes, Securing tighten all the screws once all the blades are attached. Before securing screws permanently, repeat with remaining blade arms.

Note: Tighten blade screws twice.

## LED Pan Assembly

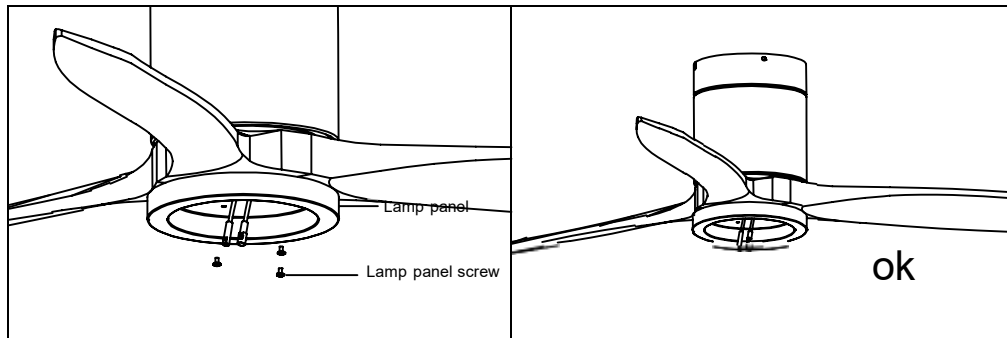







Unscrew a set screw. Attach the LED pan up to the bottom of the fan by inserting the other two set screw heads into key hole slots, rotate it to place, then secure the previous set screw by aligning screw hole and the hole at the bottom of the fan, tighten the rest two set screw to secure LED pan.

NOTE: While install or remove the LED pan, please keep the insulation pads intact carefully. Turning the set screws over-tightly or fast will damage the insulation pads.

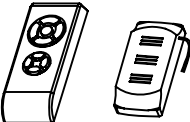
## Parts Inventory

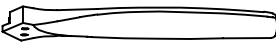
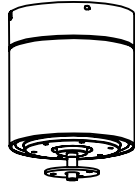
Carefully open the packaging. Remove items from Styrofoam inserts. Remove motor housing and place on carpet or Styrofoam to avoid damage to finish. Check against parts inventory that all parts have been included.

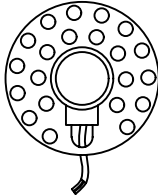
- Downrod and hanging ball

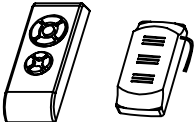
		
Hanger bracket	Remote control	Spiral package
		
Blade	Motor	Lamp panel
		
glass shade	LED light source	Spiral package
		
Remote control		

## Installing the Hanger Bracket

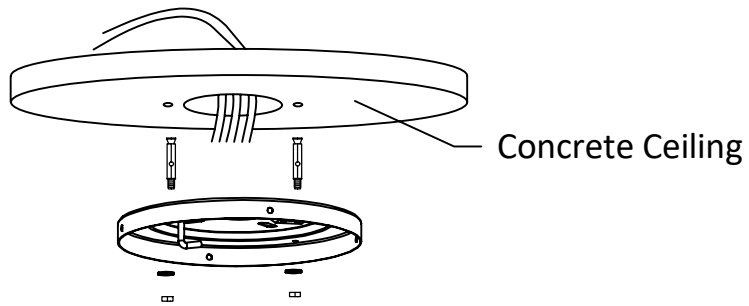
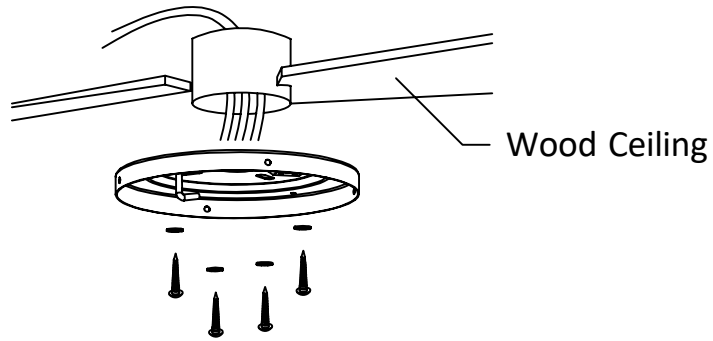

Please drill  $\phi 8\text{mm}$  hole on the concrete ceiling, and insert the bolt. Align bracket with the hole, then tighten with nut.

## Remote control connection

AC:

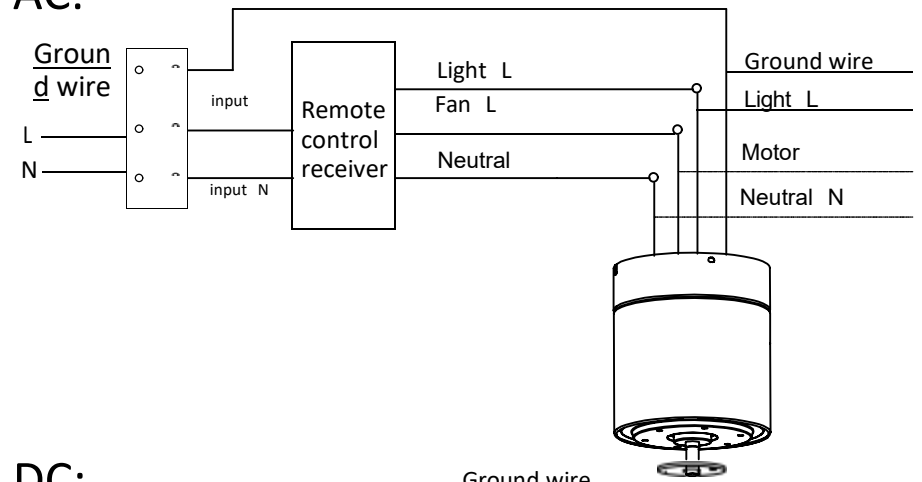

DC:

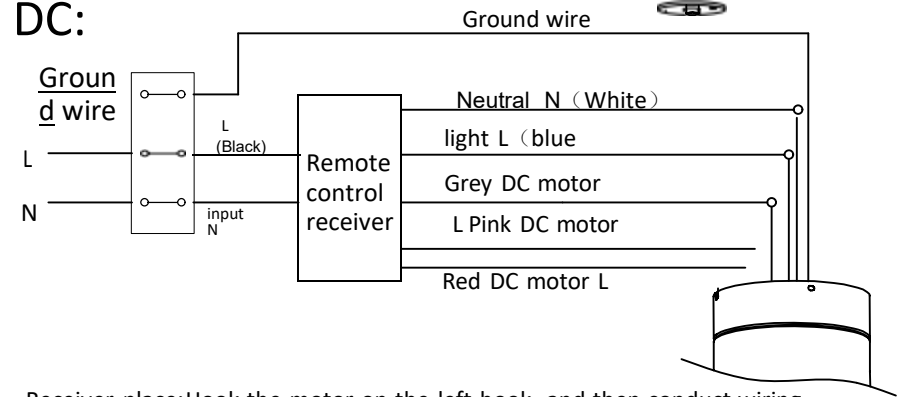

Receiver place: Hook the motor on the left hook, and then conduct wiring

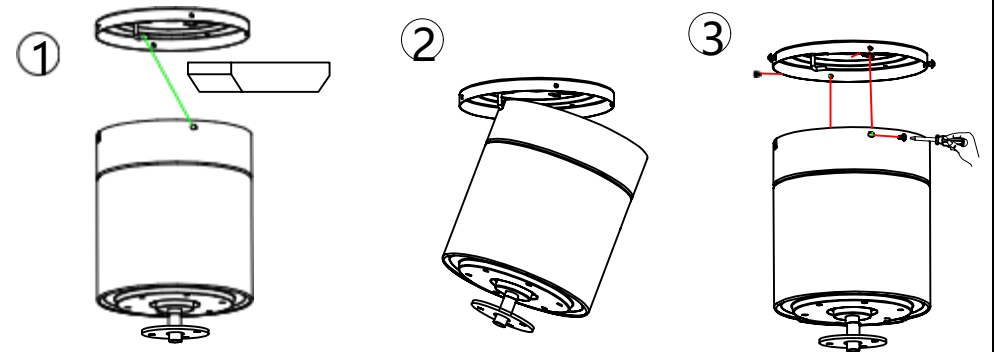

# OPTONICA

## MANUALE D'USO - VENTILATORE A LED DA SOFFITTO

SKU: 19111, 19112

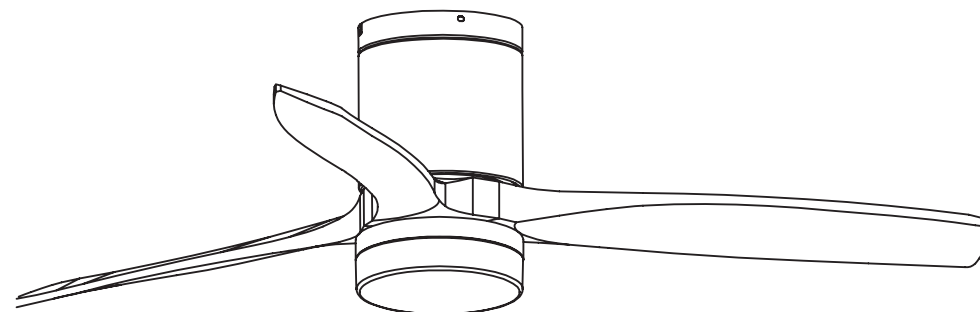

## Precauzioni e avvertenze

- LEGGERE ATTENTAMENTE L'INTERO MANUALE PRIMA DI INIZIARE L'INSTALLAZIONE. CONSERVARE QUESTE ISTRUZIONI.
- Utilizzare solo pezzi di ricambio originali.
- Per ridurre il rischio di infortuni personali, fissare direttamente il ventilatore alla struttura portante dell'edificio seguendo queste istruzioni e utilizzando solo l'hardware fornito.
- Per evitare scosse elettriche, prima di installare il ventilatore, scollegare l'alimentazione spegnendo gli interruttori del quadro elettrico relativi alla presa e all'interruttore a parete collegati. Se non è possibile bloccare gli interruttori in posizione OFF, fissare un dispositivo di avvertimento ben visibile, come un'etichetta, al pannello di servizio.
- Tutti i cablaggi devono essere conformi ai codici elettrici nazionali e locali e alla norma ANSI/NFPA 70. Se non si ha familiarità con l'impianto elettrico, rivolgersi a un elettricista qualificato.
- Per ridurre il rischio di infortuni personali, non piegare il sistema di fissaggio delle pale durante l'installazione, il bilanciamento o la pulizia del ventilatore. Non inserire oggetti estranei tra le pale rotanti.
- Per ridurre il rischio di incendio, scosse elettriche o danni al motore, non utilizzare un controllo di velocità a stato solido con questo ventilatore. Usare solo controlli di velocità originali.

NOTA: Le importanti precauzioni e istruzioni di sicurezza contenute nel manuale non coprono tutte le possibili condizioni e situazioni che possono verificarsi. È necessario comprendere che il buon senso e la prudenza sono fattori essenziali nell'installazione e nell'utilizzo di questo ventilatore.

## Lamp Shade Assembly

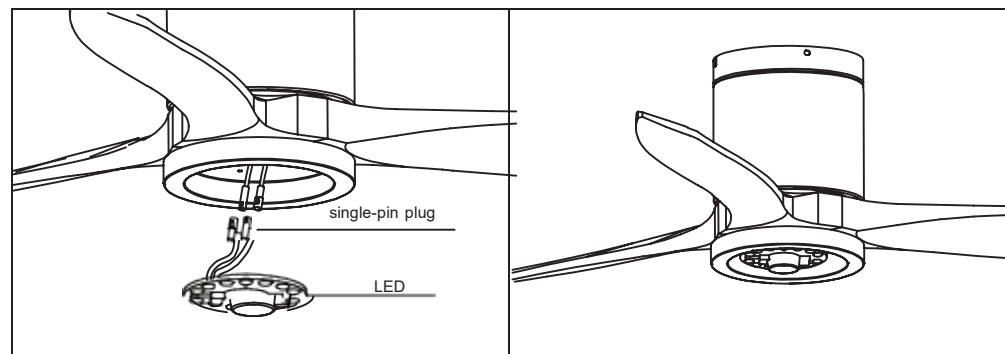

Riposizionare il coperchio e il paralume sulla piastra LED.

## Inventario di padelle decorative

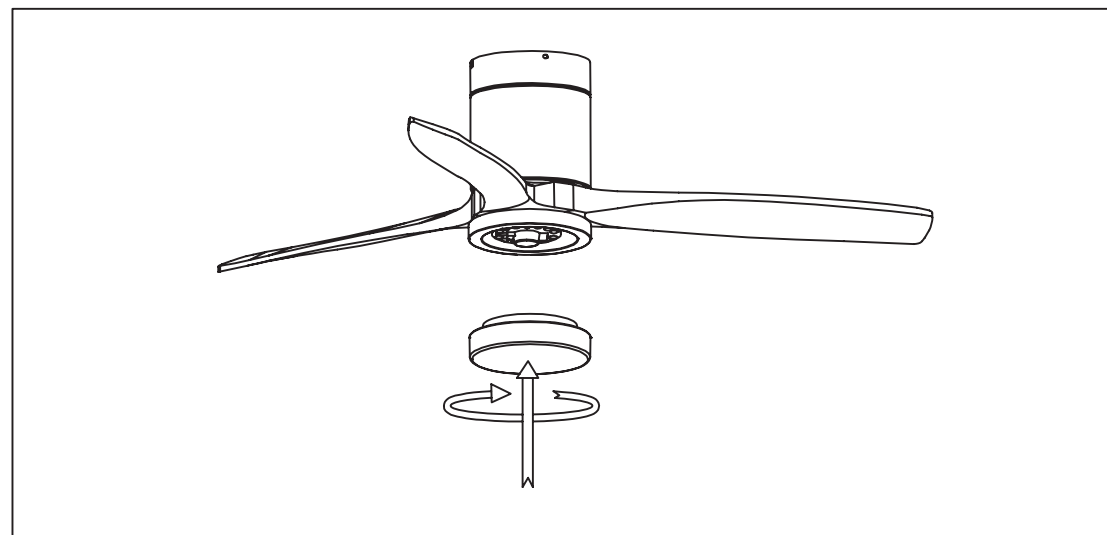

Riposizionare il coperchio e il paralume sulla piastra LED e fissarli con clip decorative e dadi a vite.

## Gruppo lama

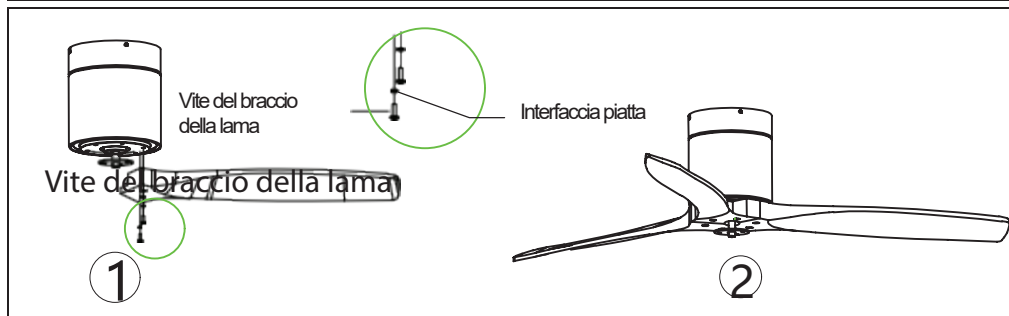

**Risparmio di tempo:** Le rondelle per le viti delle pale possono essere posizionate su ciascuna vite prima di installare le pale.  
**Allineare i fori delle pale con i fori delle viti del motore. Serrare tutte le viti una volta che tutte le pale sono state montate. Prima di serrare definitivamente le viti, ripetere l'operazione con le restanti pale.**  
**Nota:** Serrare le viti delle pale due volte.

## Gruppo LED Pan

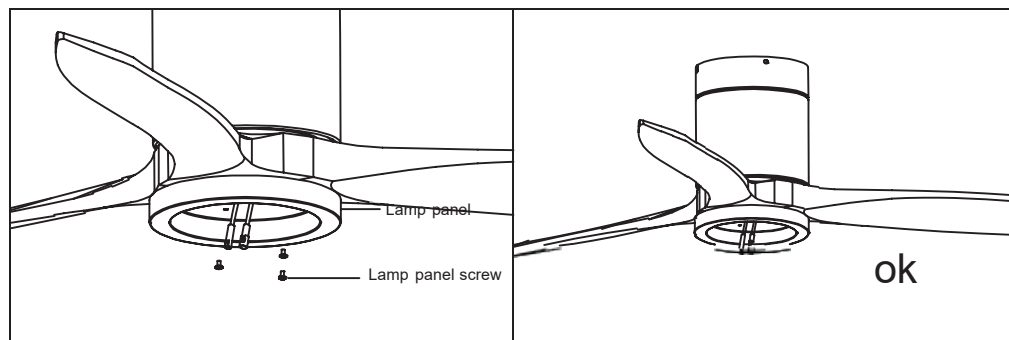





Svita una vite di fissaggio. Fissa la piastra LED alla base del ventilatore inserendo le altre due teste delle viti di fissaggio nelle apposite scanalature, ruotala in posizione, quindi fissa la vite di fissaggio precedentemente allineando il foro della vite con quello alla base del ventilatore. Infine, stringi le altre due viti per fissare la piastra LED.

**NOTA:** Durante l'installazione o la rimozione della piastra LED, fare attenzione a mantenere intatti i cuscinetti isolanti. Serrare le viti di fissaggio eccessivamente o troppo velocemente può danneggiare i cuscinetti isolanti.

## Invertitore di parti

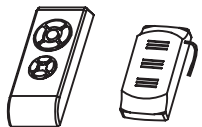
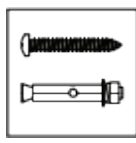
Aprire con cura l'imballaggio. Rimuovere gli articoli dagli inserti in polistirolo. Rimuovere il carter del motore e posizionarlo su un tappeto o su polistirolo per evitare danni alla finitura. Controllare l'inventario dei componenti per assicurarsi che tutte le parti siano incluse.

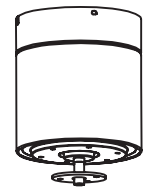
- Asta di sospensione e sfera di montaggio.

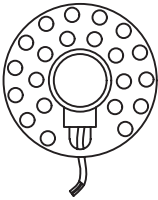
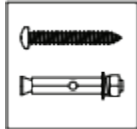
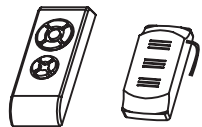
		
Staffa più alta	Telecomando	Confezione a spirale
		
Lama	Motore	Pannello lampada
		
Paralume in vetro	Sorgente luminosa a LED	Pacchetto a spirale
		
Telecomando		

## Installazione della staffa di appendamento

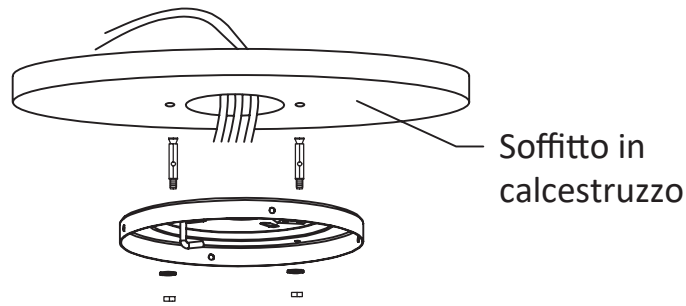
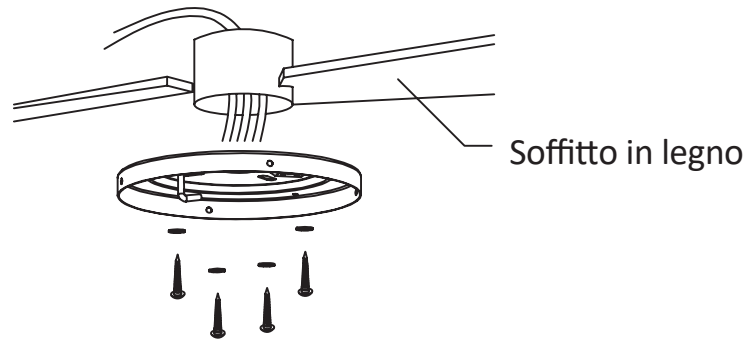

Praticare un foro di Ø8 mm nel soffitto in cemento e inserire il bullone. Allineare la staffa con il foro, quindi serrare con il dado.

## Collegamento del telecomando

AC:

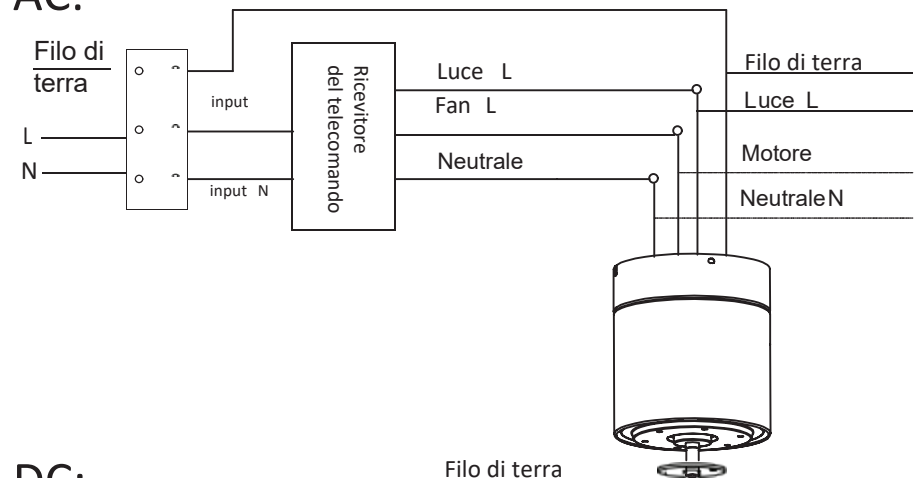

DC:

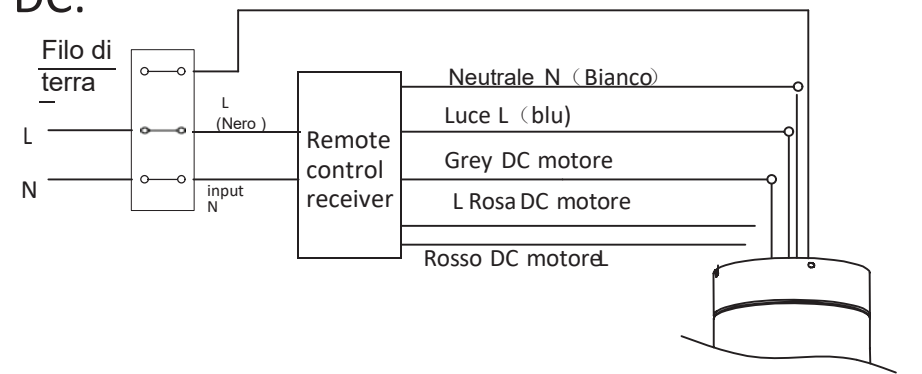

Posizione del ricevitore: Agganciare il motore al gancio sinistro, quindi eseguire il cablaggio.

