



## FEATURES:

- Easy to install, waterproof and dust proof
- High quality polysilicon solar panel
- Main light is illuminated down, and soft side light around
- Continuous dusk to dawn when full recharged
- Built-in smart battery management chip

## SPECIFICATIONS:

SKU	9352	Dimensions	105*70*40mm
Solar Panel	Polysilicon	Material	PC+ABS
Charging Time	5-6 Hours	Battery	3.7V/1200mAh Lithium Battery
LED Type	SMD 2835	Working Time	Max. 12+ Hours
Surface Colo	Matt Black	LED Q'ty	6 Pcs
IP Class	IP44	Color Temp.	3000 K
Working Temp	-10~45°C	Weight	0.116Kgs

## IMPORTANT:

- This is a solar powered light and must be installed where can get enough sunlight.
- Install in direct sunlight for best results.
- Recommended installation is facing South, with no shade or obstruction above the light.
- Keep it away from other light sources, such as street lights, corridor lights, etc. Because when the solar panel detects sufficient light from these light sources, it will mistakenly think it is daytime and the lamp will not work.
- Fallen leaves, built-up dirt or dust will affect the performance of solar charging. Please wipe off the debris gently on the solar panel with a damp cloth monthly.

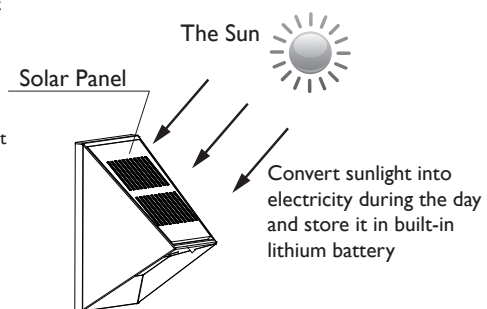

● BEFORE USING IT FOR THE FIRST TIME, PLEASE BE SURE TO CHARGE IT IN THE SUN FOR AT LEAST 8 HOURS!



When you get the light, the battery may be low due to natural discharge.

## LED Solar Garden Lights User Manual



Water Proof



Heat Resistance



Frost Resistance

## 2

### PACKAGE CONTENTS:

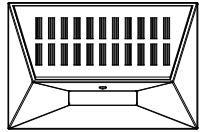

1 pc

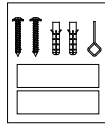

1 pc

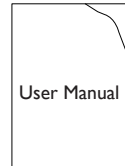

1 pc

\*There is only 1 pc user manual in each individual package.

### INSTALLATION:

Choose a place that can get enough sunshine to install the light, the more it gets sunshine, the longer it can illuminate.

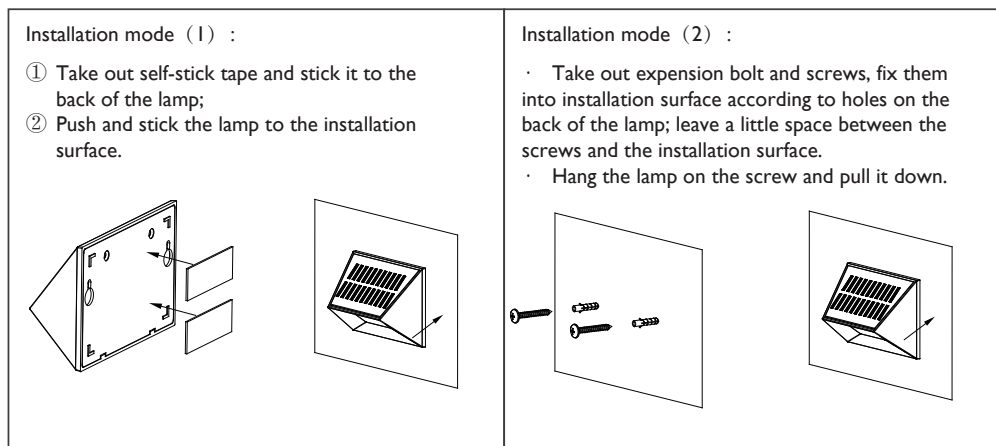

## 3

### OPERATION GUIDE:

The solar Landscape light can automatically detect surrounding brightness, it will not light up in the day, and it will automatically light up in darkness or at night. 🌙

This lamp is preset OFF. When using the lamp, please press the button;

After lighting up 4hours at full brightness, it will reduce to 30% brightness. During rainy day, if the battery is low, the brightness will be low as well.

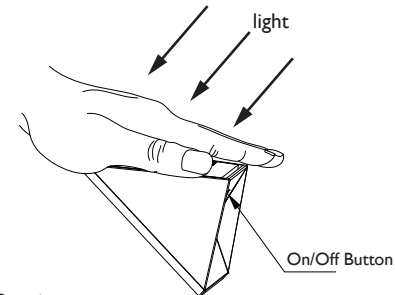
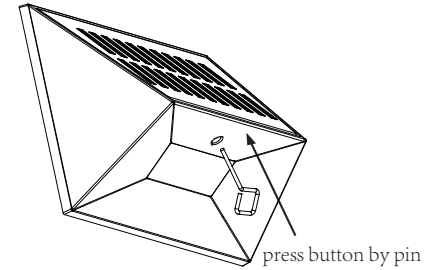

### ☀️ Daytime

During the daytime or in a bright environment, if you want to test if it works, just cover the solar panel with your hand (or your body, a book, etc.) and turn on the switch.



### Battery Protection

When the battery is extremely low, it will enter the battery protection mode and the solar Landscape light will stop working.



### About Charging

No matter which mode the power button is in, if the sun is shining enough, the solar panel will always charging until the battery is full.