

OPTONICA

LED SOLAR FLOOD LIGHT

Please take time to read this leaflet carefully and retain it for future reference.

Diagram:

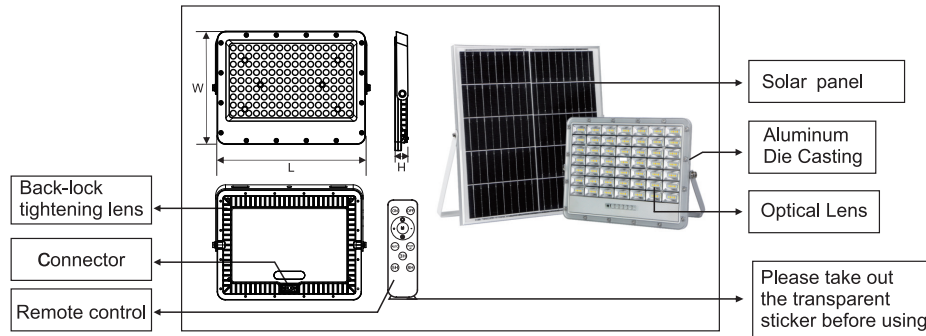

Specification:

Lamp body	Equivalent power	10 W	20 W	30 W
	LED Chip		SMD283	
	Size(LXWXH)	222x160x22mm	288x207x22mm	354x249x23mm
Battery	Capacity	10000mAh	20000mAh	30000mAh
	Power	5V/10W	5V/20W	5V/30W
Solar Panel	Material	Monocrystalline		
	Size	350X235X17mm	350X350X17mm	350X530X17mm
	CCT	6000K/4000K/3000K CCT		
	CRI	80		
	IP Rating	IP65		
	Working temperature	-20°C~+40°C		

10W, 20W, 30W:

- Charging time with solar irradiation is 5-8 hours, but there are many factors due to the processes of usage and region with customers.
- Discharge time, our mode is 100% brightness in the first hour, 80% brightness in the second hour, 60% brightness in the third hour, 50% brightness in the fourth hour, 30% brightness in the fifth to sixth hour. It will not be extinguished until dawn and switch to charging mode.
- Timing function: 3H, 5H, 8H
- Another mode is brightness adjustment mode, which is indicated on remote control.
- Best effect, recommended use of "AUTO" automatic mode.
- Usually power on (installed) is defaulted to automatic mode.
- Automatic mode: The brightness of the whole lamp can be adaptively controlled according to the battery's own power.

Important Safety Information

- Do not dispose of battery in fire. This may result in an explosion.
- Do not expose the light to fire or intense heat as the battery may explode.
- Do not immerse in water.
- Never look directly into the light or shine it into another person's eyes.
- Follow proper safety tips to prevent from falling off a ladder.

Fixing instructions

- The light fixture should be installed on a flat and stable surface.
- Avoid installing the light near an air conditioner, a central heater, or high voltage system.
- The solar charger board should be set in a sunny area where maximum sunlight can be collected. Typically, the solar board should face a direction (south) where sunlight can charge the board for at least 3 hours per day (5 hours per day if behind glass). It is suggested to charge the light for 24 hours before first use.
- Use a soft wet cloth to periodically (at least once a year) clean the charger board to avoid the reduction of power output due to accumulated dust.

Installation:

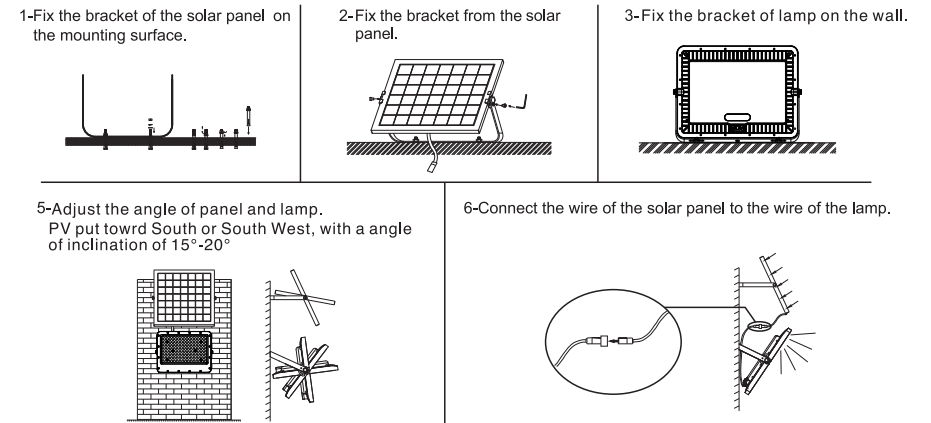

Remote control introduction

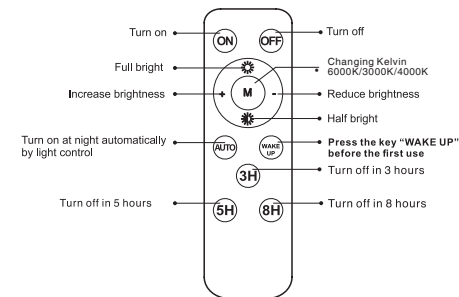

Quick Setup Procedure

Warning!

1. Please keep it away from the children.
2. This product can installed for outdoor, but we

Note : Please bring the following tools

